

SUPER DOUBLE WIDE POCKET

134 / 234 / 334

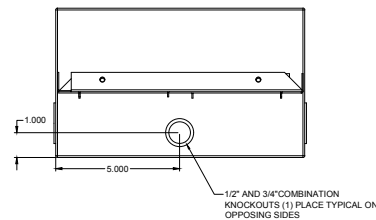

PROUDLY MADE IN THE U.S.A.

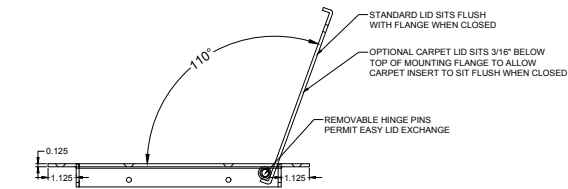
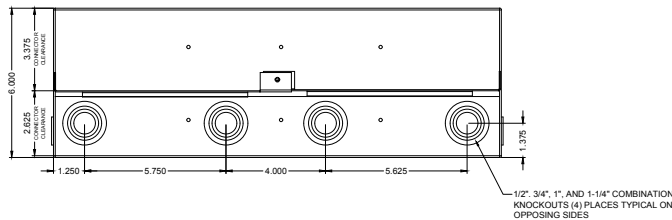
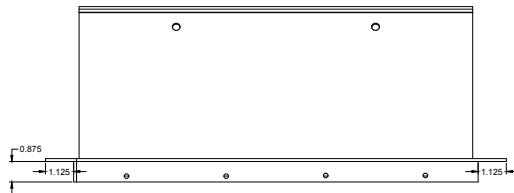
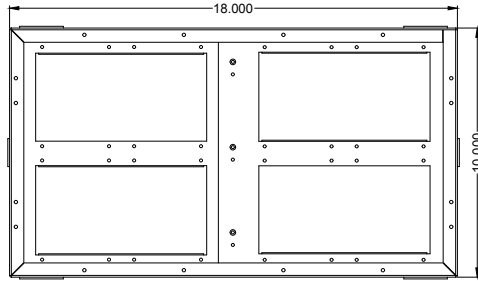
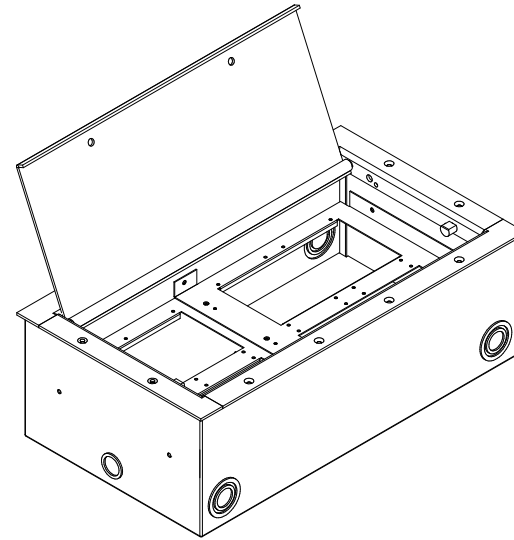
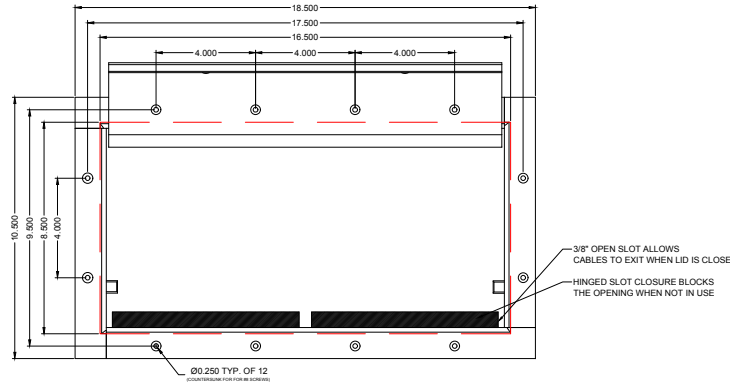

REVISION: 11/2019

BEZEL/LID FINISH CHOICES:

- Textured Black Electrostatic Powder Coat
- Coppervein Electrostatic Powder Coat
- Solid Brushed Brass
- Solid Brushed Stainless Steel

CAPACITY:

Up to (50) Connectors
OR 36 connectors (2) AC Duplex
Compatible with **CONNECTRIX** Panels and Connectors.

DESCRIPTION:

The extra large capacity Super Double Wide Pocket System has horizontal panel brackets and a choice of Lid or Finish. The Pocket Body is made from 14ga CRS and mating Bezel/Lid Assembly from 11ga CRS or half hard Brass or Stainless Steel.

REV
1
SHEET
1 OF 1

ALL DIMENSIONS ARE FOR REFERENCE ONLY. ALL DIMENSIONS ARE IN INCHES